

## **200 series**

*rotary machines for filling  
& closing pre-formed containers*

**Trepko**

## 200 Series – a flexible choice

Trepko's 200 Series provide flexible and effective solutions for filling & closing pre-formed containers. The machinery within this range achieves outputs from 2,400 up to 14,000 cups/hour. Four machine sizes are available (210-220-230-240) dependent on the required output, container size and options required, each with different frame sizes and number of lanes.

Thanks to their versatility the 200 Series machines meet small, medium and high production needs where areas are limited by production space. The compact construction of this machinery allows for efficient use of floor-space at the customer's production facilities.

The design of the 200 Series utilises a rigid, stainless steel frame, reliable drive solutions and state of the art technology throughout. PLC units are equipped with touch-screen panels with user-friendly software to simplify the operation. Central lubrication systems, modern materials and high quality construction contribute to easy and cheap maintenance.

The machine complies with the strictest hygiene requirements in the food industry. The frame and external surfaces are manufactured from stainless steel in order to guarantee the machine's long life in an aggressive and humid environment. The packaging hygiene can be enhanced by a number of optional features such as CIP facility for the filling systems and sterile air cabinets etc. For larger frame sizes, cup sterilization options are also available.

Ever mindful of quick changing markets the 200 Series versatility guarantees that new packaging ideas can be accommodated. The 200 Series represents full production flexibility in terms of product and container changes. Extra product depositors can be installed for pre or post-filling of semi-liquid or dry products. Utilising the cassette concept allows changeover times of under 20 minutes between alternative sizes of packaging.

Due to a great number of possible combinations of frame size and options Trepko's 200 Series meet even the most sophisticated customer requirements. Every machine is specially designed to meet individual customer requirements.



# FILLED WITH PRIDE,

## 210 MODEL

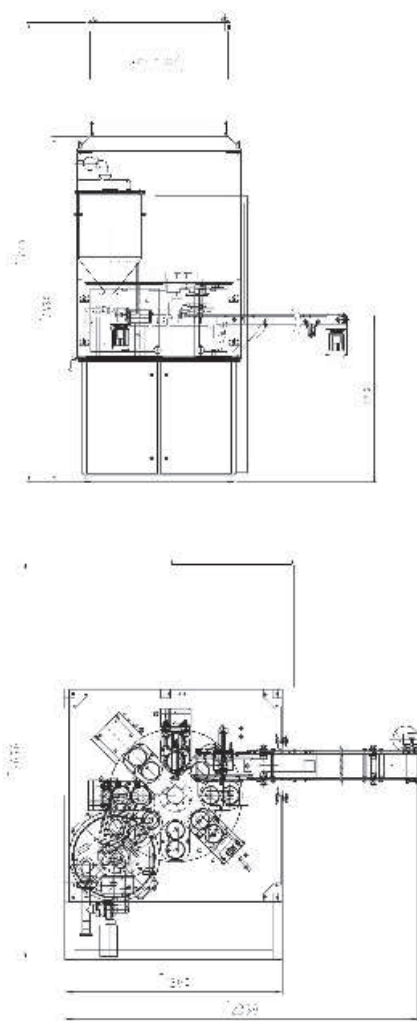

### SPECIFICATIONS

• Number of lanes (for a Ø 95 mm cup)	2
• Maximum output	4.800 cups / h
• Power supply	3 x 400 V + PE + N
• Power consumption	ca. 4,7 kVA
• Compressed air pressure	6 bar
• Compressed air consumption	36 m <sup>3</sup> /h

## 220 MODEL

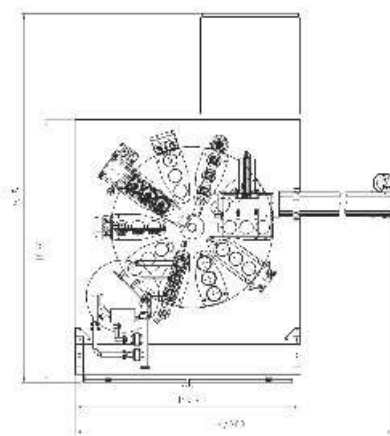
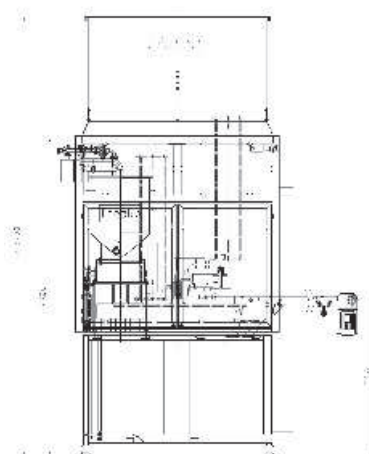

### SPECIFICATIONS

• Number of lanes (for a Ø 95 mm cup)	3
• Maximum output	7.200 cups / h
• Power supply	3 x 400 V + PE + N
• Power consumption	ca. 7,0 kVA
• Compressed air pressure	6 bar
• Compressed air consumption	45 m <sup>3</sup> /h



## 230 MODEL

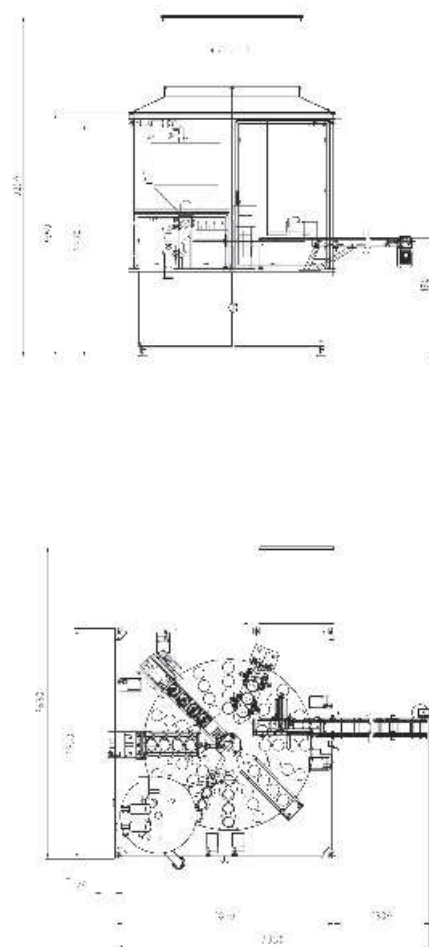

### SPECIFICATIONS

• Number of lanes (for a Ø 95 mm cup)	4
• Maximum output	9,600 cups / h
• Power supply	3 × 400 V + PE + N
• Power consumption	ca. 8,4 kVA
• Compressed air pressure	6 bar
• Compressed air consumption	50 m <sup>3</sup> /h

## 240 MODEL

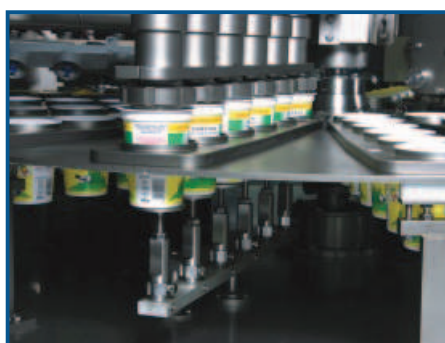
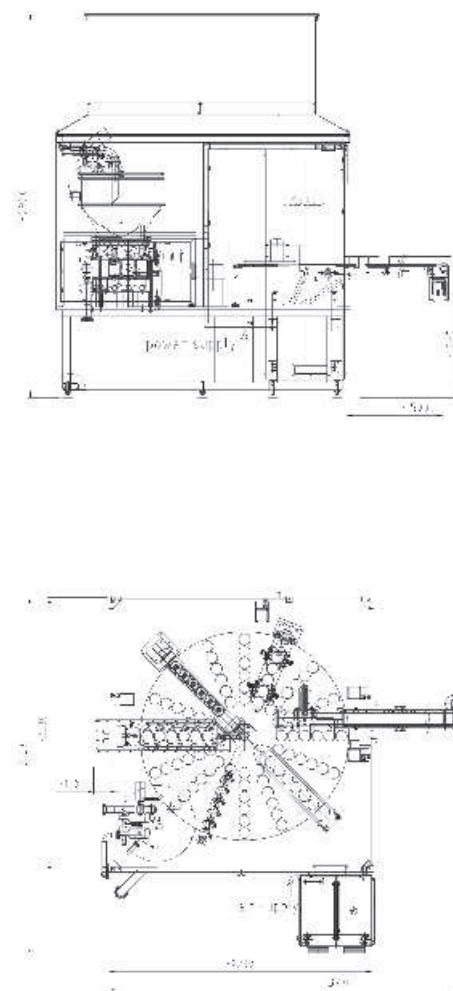

### SPECIFICATIONS

• Number of lanes (for a $\varnothing$ 95 mm cup)	6
• Maximum output	14.000 cups / h
• Power supply	3 x 400 V + PE + N
• Power consumption	ca. 11,5 kVA
• Compressed air pressure	6 bar
• Compressed air consumption	60 m <sup>3</sup> /h

## Options\*

	210 model	220 model	230 model	240 model
<b>HYGIENE OPTIONS</b>				
Laminar flow cabins	•	•	•	•
CIP/SIP of dosers	•	•	•	•
UV radiation of cups			•	•
UV radiation of lids			•	•
Chemical sterilisation				•
Gas flush	•	•	•	•
<b>EFFICIENCY OPTIONS</b>				
Cup/lid stack feeding magazines		•	•	•
Foil-sledge		•	•	•
Automatic volume adjustment	•	•	•	•
Automatic weight adjustment	•	•	•	•
<b>CLOSING OPTIONS</b>				
Heat-sealed die-cut foil	•	•	•	•
Foil from reel		•	•	•
Vacuum heat sealing		•	•	•
Snap-on lids	•	•	•	•
<b>DOSING &amp; PRODUCT IN-FEED</b>				
Pre or post-dosing	•	•	•	•
Dry filling	•	•	•	•
Compensator	•	•	•	•
Horizontal or vertical hoppers	•	•	•	•
<b>OTHER OPTIONS</b>				
Date marking systems	•	•	•	•
Telephone modem	•	•	•	•

(\*) subject to number of lanes, cup size and the machine's configuration



# SEALED WITH QUALITY

**Head Office**  
TREPKO A/S  
Kuldysen 15-17  
2630 Taastrup  
Denmark  
tel. +45 43 99 22 44  
fax +45 43 99 26 55

**United Kingdom, Ireland**  
TREPKO (UK) Limited  
Marshall Way  
Heapham Road Ind. Estate  
Gainsborough, Lincolnshire  
England, DN21 1GD  
tel. +44 1427 612244  
fax +44 1427 617797

**Central & Eastern Europe**  
TREPKO Sp. z o.o.  
ul. Roosevelta 116  
62-200 Gniezno  
Poland  
tel. +48 61 426 50 41  
fax +48 61 426 50 18

**End of Line Solutions**  
TREPKO AB  
Maskingatan 2-4  
Box 551, 441 16 Alingsås  
Sweden  
tel. +46 322 66 86 00  
fax +46 322 66 86 90

**Middle East & North Africa**  
TREPKO A/S - Regional Office  
P.O. Box 58  
Al-Andalus 11817  
Cairo - Egypt  
mobile: +2012 32 19 274  
tel./fax +202 227 34 613

**North America**  
Trepko North America  
W3835 Hwy H  
Fredonia  
WI-53021  
USA  
tel./fax +1 (262) 339-5482

**info@trepko.com**  
**www.trepko.com**

**World wide supplier**  
*of* **filling/closing machines**

